

**Lecmax**  
KOREA DOOR

**Premium Products**



[www.lecmax.com](http://www.lecmax.com)

# HIGH-LEVEL PRODUCTS PERFECT CHOICE

## CONTENT

- PAINTING DOOR
- MULTI COLOR DOOR
- LUXURY DOOR

# Lecmax

KOREA DOOR

SAFTY

LUXURY

STYLE

DIVERSITY

FRIENDLY





# PAINTING DOOR



## Standard Size

W (900, 1000, 1100) x H (2000, 2100, 2200)



**LM - KOREA PT01**



**LM - KOREA PT02**



**LM - KOREA PT03**



**LM - KOREA PT04**



**LM - KOREA PT05**



**LM - KOREA PT06**



**LM - KOREA PT07**



**LM - KOREA PT08**



**LM - KOREA PT09**



**LM - KOREA PT10**



**LM - KOREA PT11**

**Lecmax**  
KOREA DOOR



# PAINTING DOOR



**LM - KOREA PT12**



**LM - KOREA PT13**



**LM - KOREA PT14**



**LM - KOREA PT15**



**LM - KOREA PT16**



**LM - KOREA PT17**



**LM - KOREA PT18**



**LM - KOREA PT19**



**LM - KOREA PT20**



**LM - KOREA PT21**

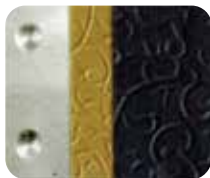

**LM - KOREA PT22**



**LM - KOREA PT23**



LM - KOREA PT24



LM - KOREA PT25



LM - KOREA PT26



LM - KOREA PT27



**LM - KOREA PT28**

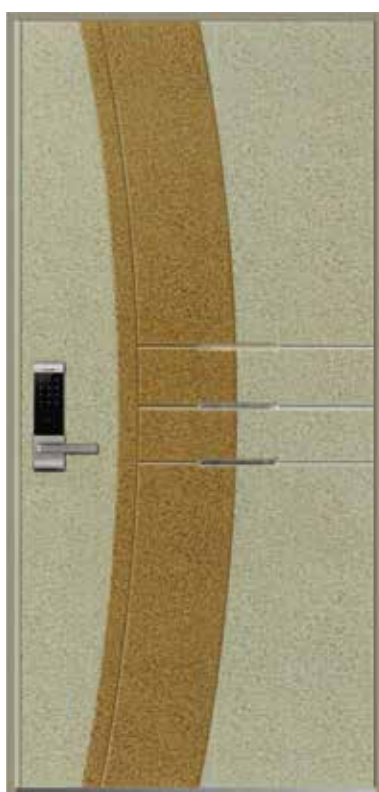

**LM - KOREA PT29**



**LM - KOREA PT30**



**LM - KOREA PT31**



LM - KOREA PT32



LM - KOREA PT33



LM - KOREA PT34



LM - KOREA PT35



**LM** - KOREA PT36



**LM** - KOREA PT37



**LM** - KOREA PT38



**LM** - KOREA PT39



# MULTI COLOR DOOR

## Standard Size

W (900, 1000, 1100) x H (2000, 2100, 2200)



**LM - KOREA MT01**



**LM - KOREA MT02**



**LM - KOREA MT03**



**LM - KOREA MT04**



LM - KOREA MT05



LM - KOREA MT06

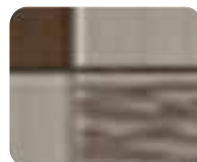

LM - KOREA MT07



LM - KOREA MT08



**LM - KOREA MT09**



**LM - KOREA MT10**



**LM - KOREA MT11**



**LM - KOREA MT12**



# MULTI COLOR DOOR



**LM - KOREA MT13**



**LM - KOREA MT14**

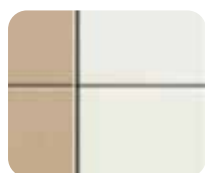

**LM - KOREA MT15**



**LM - KOREA MT16**



LM - KOREA MT17



LM - KOREA MT18



LM - KOREA MT19



LM - KOREA MT20



**LM - KOREA MT21**



**LM - KOREA MT22**

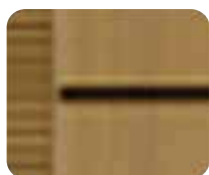

**LM - KOREA MT23**



**LM - KOREA MT24**



LM - KOREA MT25



LM - KOREA MT26

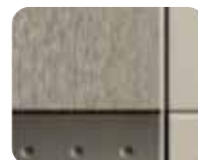

LM - KOREA MT27



LM - KOREA MT28



**LM - KOREA MT29**



**LM - KOREA MT30**



**LM - KOREA MT31**

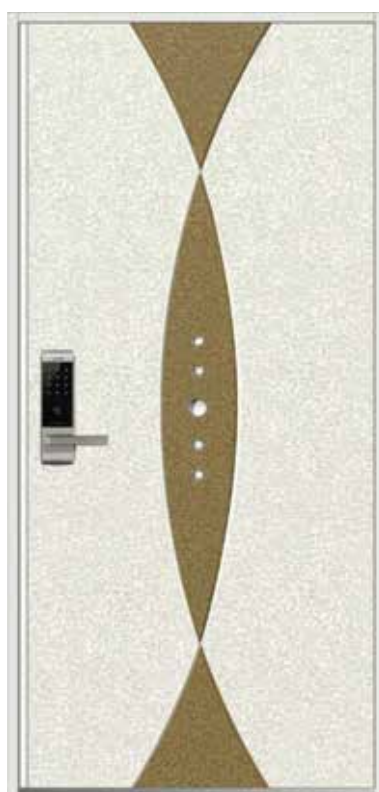

**LM - KOREA MT32**



# DECOR DOOR

## Standard Size

W (900, 1000, 1100) x H (2000, 2100, 2200)



LM - KOREA DC01



LM - KOREA DC02

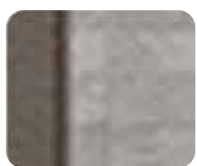
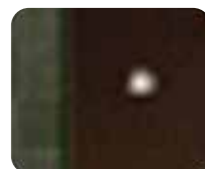

LM - KOREA DC03



LM - KOREA DC04



LM - KOREA DC05



LM - KOREA DC06

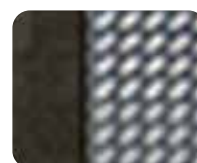

LM - KOREA DC07



LM - KOREA DC08



**LM** - KOREA DC09



**LM** - KOREA DC10

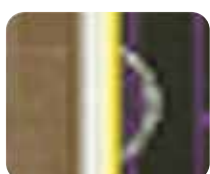

**LM** - KOREA DC11



**LM** - KOREA DC12



# LUXURY DOOR

## Standard Size

W (900, 1000, 1100) x H (2000, 2100, 2200)



**LM** - KOREA LX01



**LM** - KOREA LX02

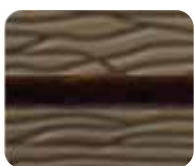

**LM** - KOREA LX03



**LM** - KOREA LX04

**Lecmax**  
KOREA DOOR



**LUXURY DOOR**

## Standard Size

W (900, 1000, 1100) x H (2000, 2100, 2200)



LM - KOREA LX05



LM - KOREA LX06



LM - KOREA LX07



LM - KOREA LX08



LM - KOREA LX09



LM - KOREA LX10



LM - KOREA LX11



LM - KOREA LX12



LM - KOREA LX13



**LM - KOREA LX14**



**LM - KOREA LX15**



**LM - KOREA LX16**



**LM - KOREA LX17**

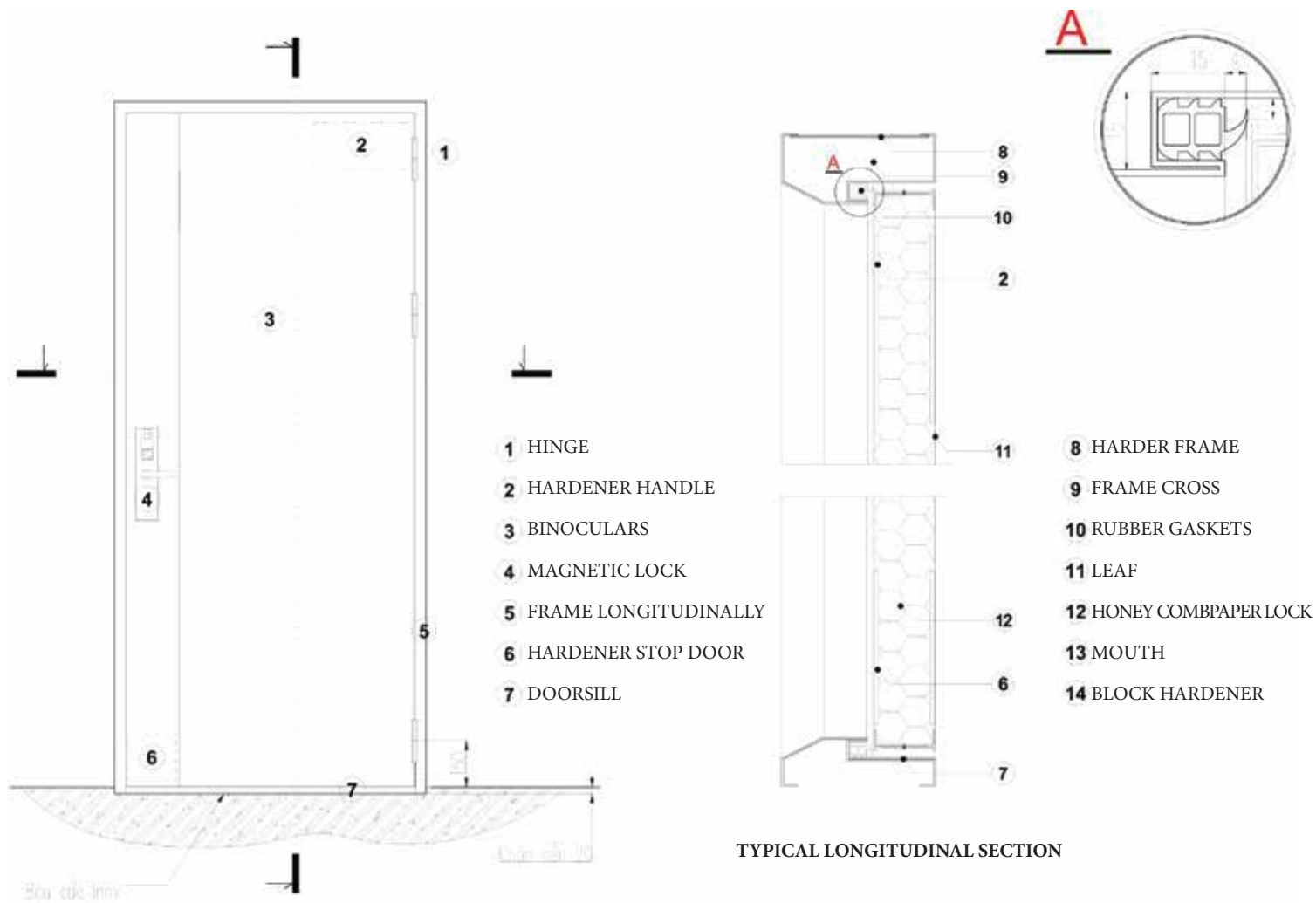

#### STANDARD SIZE:

|                      |                 |  |
|----------------------|-----------------|--|
| Leaf thickness       | 45              |  |
| Leaf steel thickness | 0.7 - 1.6       |  |
| Frame depth          | 110             |  |
| Frame steel          | 1.2 - 1.6       |  |
| Materials            | Honey combpaper |  |

#### STANDARD SIZE:

|        |                        |
|--------|------------------------|
| Width  | 900, 1000, 1100, 1200  |
| Height | 2000, 2100, 2200, 2400 |

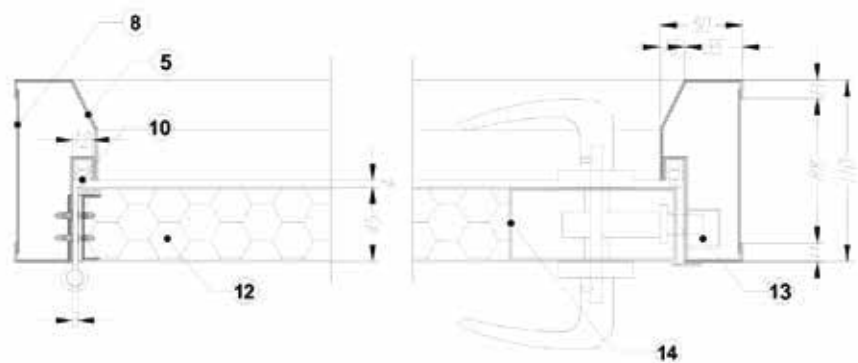

#### CONVENTION OPENING DIRECTION





### Soundproofing function:

Due to using the special soundproofing materials, the door frame is fitted with soundproofing rubber gaskets so that the soundproofing function of the door is ensured and perfect.



### Heatproofing function - anti waterproof:

A Due to in the winter, the temperature get down, so to avoid water in the door and mold around the door the manufacturer applies heatproofing function and anti waterproof for the leaf door and the frame door, thereby maintaining comfortable indoor space.



### New design:

The design uses modern and useful material, so when installed it will be very suitable for the interior of the apartment.

### The soundproof lining:

Fastened to the door frame, it further enhances the sound insulation, smoke resistance functions.

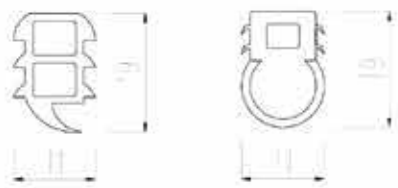

### Embo EGI material:

#### 1) General

The galvanized steel is used by using zinc coating on the surface of cold-rolled steel sheets (CR) of galvanized steel, using the anticorrosion electrolyte currents, although less in coatings than galvanized steel, uniform coating, smooth and beautiful surface, due to not affected by the heat during the coating should maintain the durability.

#### 2) Features

- In the process of plating, the crust is not shattered, so the quality does not change even when outsourcing or compressing the product.
- Steel plates are used for a variety of purposes because zinc is coated evenly in accordance with the principle of electroplating so that the surface is beautiful, and the adhesion is good.

#### 3) Using

This product can be used for apartment doors and household products.



### Real Hairline:

Due to its is color painted and thin line on the steel plate, it not only describes the appearance of stainless steel, but also has a wide variety of colors. By process Hairline , the surface of the product like stainless steel and the color of the product is very luxurious.

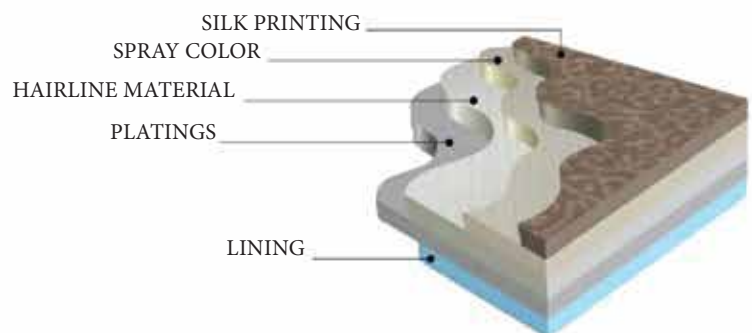

OUTSOURCING MATERIALS PROCESSING C.N.F





LM - KOREA PT01 LM - KOREA PT02 LM - KOREA PT03 LM - KOREA PT04 LM - KOREA PT05 LM - KOREA PT06 LM - KOREA PT07 LM - KOREA PT08 LM - KOREA PT09 LM - KOREA PT10



LM - KOREA PT11 LM - KOREA PT12 LM - KOREA PT13 LM - KOREA PT14 LM - KOREA PT15 LM - KOREA PT16 LM - KOREA PT17 LM - KOREA PT18 LM - KOREA PT19 LM - KOREA PT20



LM - KOREA PT21 LM - KOREA PT22 LM - KOREA PT23 LM - KOREA PT24 LM - KOREA PT25 LM - KOREA PT26 LM - KOREA PT27 LM - KOREA PT28 LM - KOREA PT29 LM - KOREA PT30



LM - KOREA PT31 LM - KOREA PT32 LM - KOREA PT33 LM - KOREA PT34 LM - KOREA PT35 LM - KOREA PT36 LM - KOREA PT37 LM - KOREA PT38 LM - KOREA PT39



LM - KOREA MT01 LM - KOREA MT02 LM - KOREA MT03 LM - KOREA MT04 LM - KOREA MT05 LM - KOREA MT06 LM - KOREA MT07 LM - KOREA MT08 LM - KOREA MT09 LM - KOREA MT10



LM - KOREA MT11 LM - KOREA MT12 LM - KOREA MT13 LM - KOREA MT14 LM - KOREA MT15 LM - KOREA MT16 LM - KOREA MT17 LM - KOREA MT18 LM - KOREA MT19 LM - KOREA MT20



LM - KOREA MT21



LM - KOREA MT22



LM - KOREA MT23



LM - KOREA MT24



LM - KOREA MT25



LM - KOREA MT26



LM - KOREA MT27



LM - KOREA MT28



LM - KOREA MT29



LM - KOREA MT30



LM - KOREA MT31



LM - KOREA MT32



LM - KOREA LX01



LM - KOREA LX02



LM - KOREA LX03



LM - KOREA LX04



LM - KOREA LX05



LM - KOREA LX06



LM - KOREA LX07

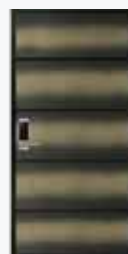

LM - KOREA LX08



LM - KOREA LX09



LM - KOREA LX09



LM - KOREA LX19



LM - KOREA LX20



LM - KOREA LX21



LM - KOREA LX22



LM - KOREA LX23



LM - KOREA LX24



LM - KOREA LX25



**Lecmax**  
KOREA DOOR



Ha Noi: F 28, Ellipse Tower, 110 Tran Phu Street, Ha Dong District, Ha Noi

Tel: (+84) 24 3823 5588 \* Fax: (+84) 24 3354 5267

HCM: No 25, Road No. 3, Quarter 6, Ward Truong Tho, Thu Duc District, HCM

Tel: (+84) 28 3894 1836 \* Fax: (+84) 28 3894 1845

Nhà Máy: Lot D, Chau Son Industrial Zone, Le Hong Phong Ward, Phu Ly City, Ha Nam